

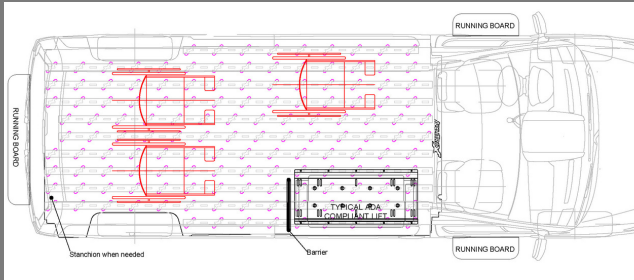

U.S. General Services Administration

GSA Solicitation # 47QMCA20R0013 FY 2021

Standard Item 282 ProMaster
Wheelchair Van Side Lift
6 Seats / 3 WC

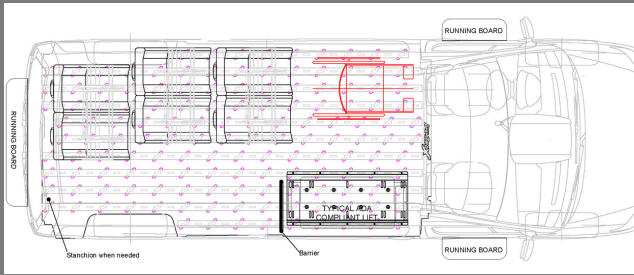

Option DESD: Dual Entry Side Door Shift-N- Step

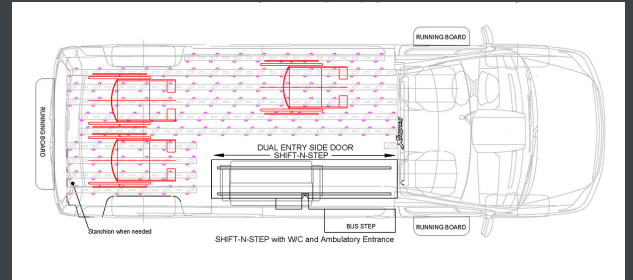
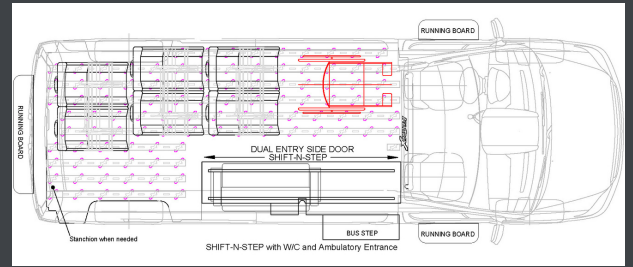

SIN 282 Includes:

- RAM ProMaster 2500, 159" Wheelbase
- Braun Side Lift (Optional Shift-N-Step)
- AbiliTrax Flexible Flooring System
- Seating for Six, Tool Free Removable CAM2 Seating
- Dual Shoulder Brackets
- Qty (3) Wheelchair Securements
- Optional Right Hand Cargo Door Grab Bar
- Safety Triangles, Fire Extinguisher, Reflective Stickers
- Cargo Door Running Boards



TO ORDER CONTACT:

Mary Gabalski
GM / Ordering Officer
Phone: (716) 484-7014 Ext. 901
Email: mary@abilitrax.com

