

SERVICE BULLETIN

Purpose:

- Braun Lift Pin Adapter (FEN-BLPA-P1) is used when attaching the Lift Support Bracket (SNSABLSW02) for the Shift n Step to the Braun Lift

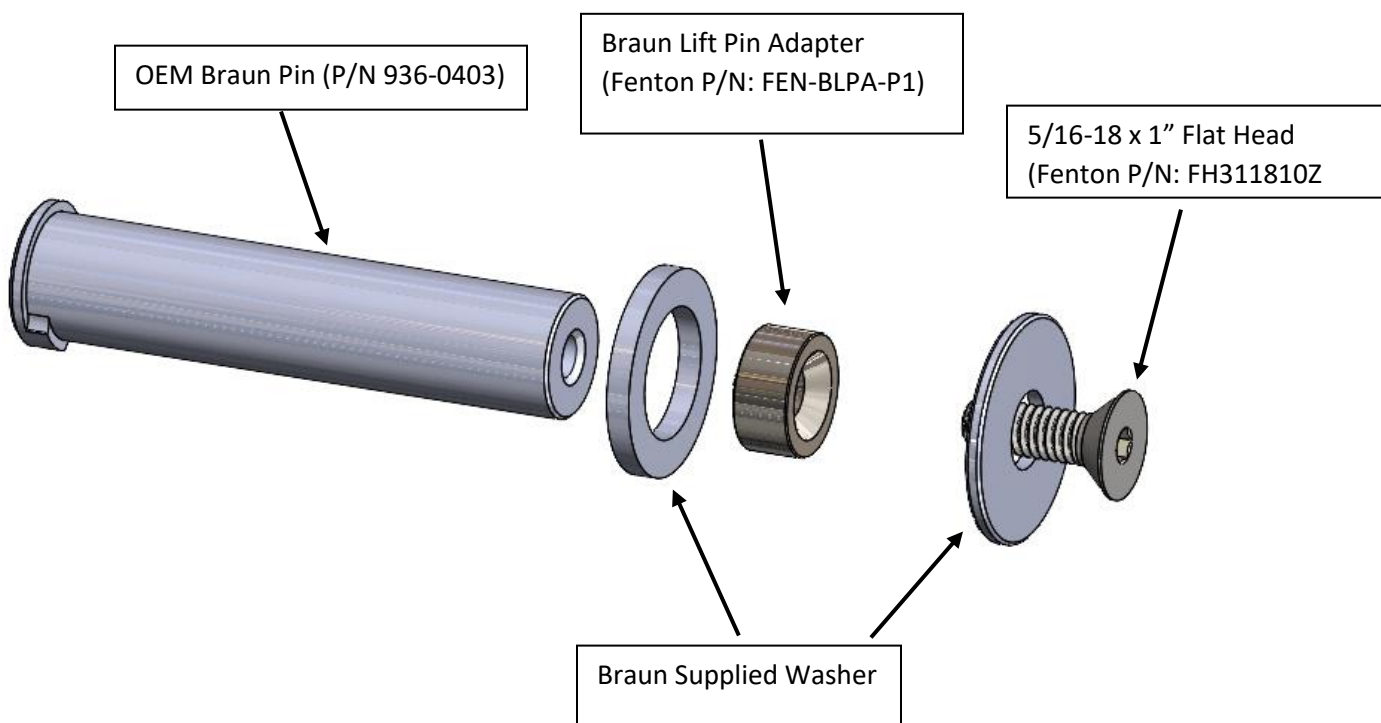

- This is a **direct replacement** for the Braun Lift Pin (Braun P/N: 936-0402XL & Fenton P/N: BRA939-0403XL)

Specifications:

- Torque Specs - 17ft lbs Min & 20ft lbs Max
- Thread Locker- Blue Loctite or Equal